

LiFeKinnex WiFi Setup Guide

This Guide will go through the steps to connect your LiFeKinnex device to your WiFi and add it to eKinnex.

1 Contact Ergotron to set up user account

To connect to eKinnex, you will first need to have Ergotron set up your cloud organization and user account.

Contact Ergotron directly at

www.ergotron.com/ekinnex-support

Phone: 844-243-6244

2 Download and install LiFeKinnex software

Use a PC that has an internet connection. Ensure this PC stays powered ON (and not powered by the LiFeKinnex device that is being set up) during the setup process that may include a firmware update to the LiFeKinnex device where the device will be power off and then back on.

Download software:

Click on 'Download Setup Tool' at this web address:

<https://www.ergotron.com/en-us/support/ekinnex/ekinnex-for-lifekinnex>

Install downloaded software:

Double click on: 'lifekinnex_setup_[VERSION].exe'.

Follow the prompts to install.

After installation, open LiFeKinnex software.

If you see the LiFeKinnex dashboard, the installation is successful.

If the installation is not successful, please uninstall the LiFeKinnex software from control panel and follow the above installation steps accurately.

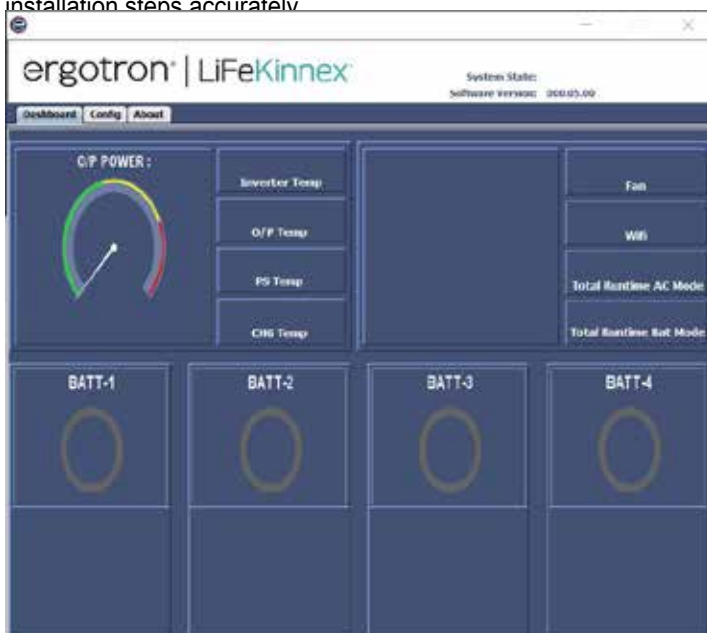

LiFeKinnex Dashboard

3 Connect LiFeKinnex device to WiFi

Plug in power cord and turn LiFeKinnex device on.

Smart Dock

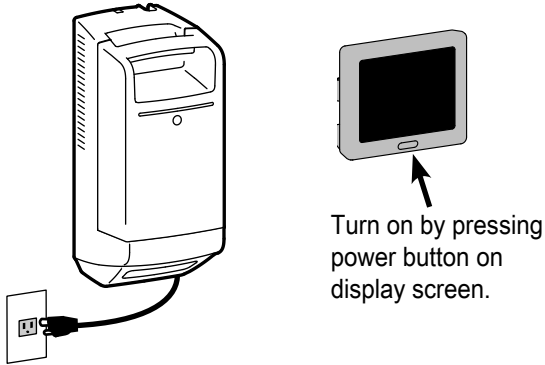

Plug USB cable into LiFeKinnex device.
Remove dock from cart.
Lower cart to allow more cable slack to set dock on the floor.

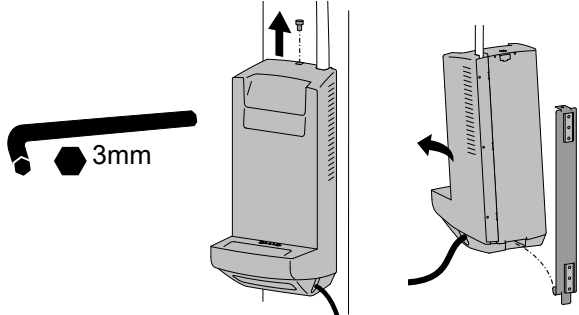

Note: USB jack is underneath the cable management cover.

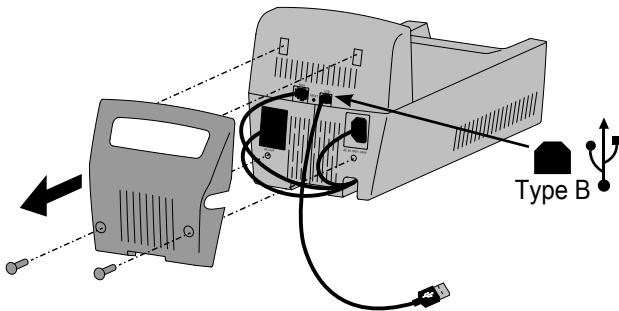

With LiFeKinnex software open, plug USB cable into computer.
If a firmware update is available, update firmware now.

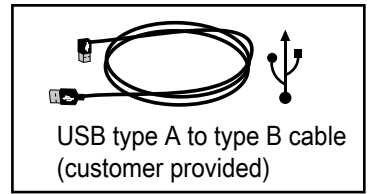
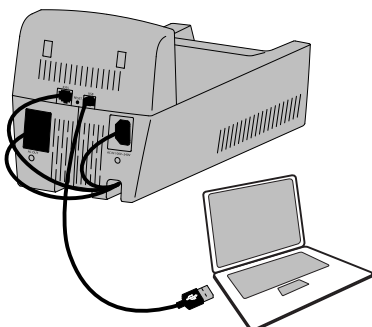

4-Bay Charger

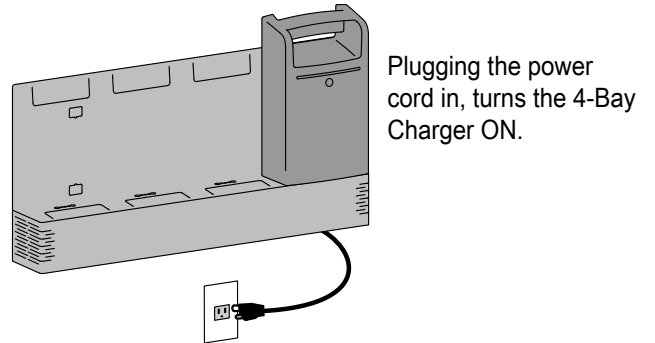

Plug USB cable into LiFeKinnex device.

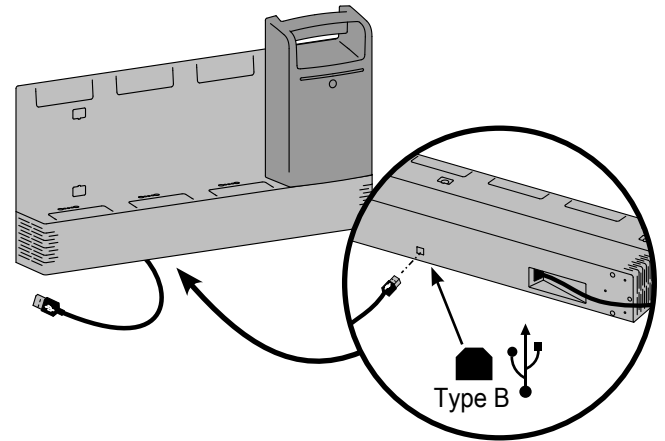

With LiFeKinnex software open, plug USB cable into computer.
If a firmware update is available, update firmware now.

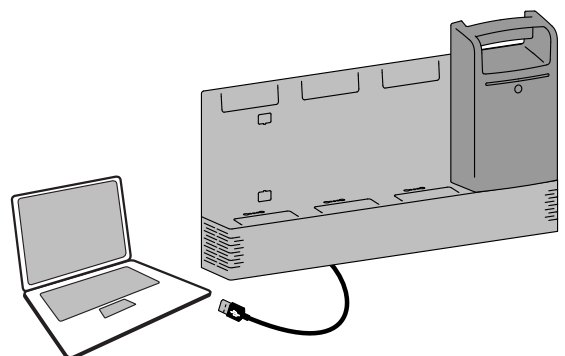

From the LiFeKinnex dashboard, click on 'Config' tab.

Enter SSID and password of your organizations WiFi network.

SSID: Max 32 characters

Password: Max 64 characters

Click on 'Write all'.

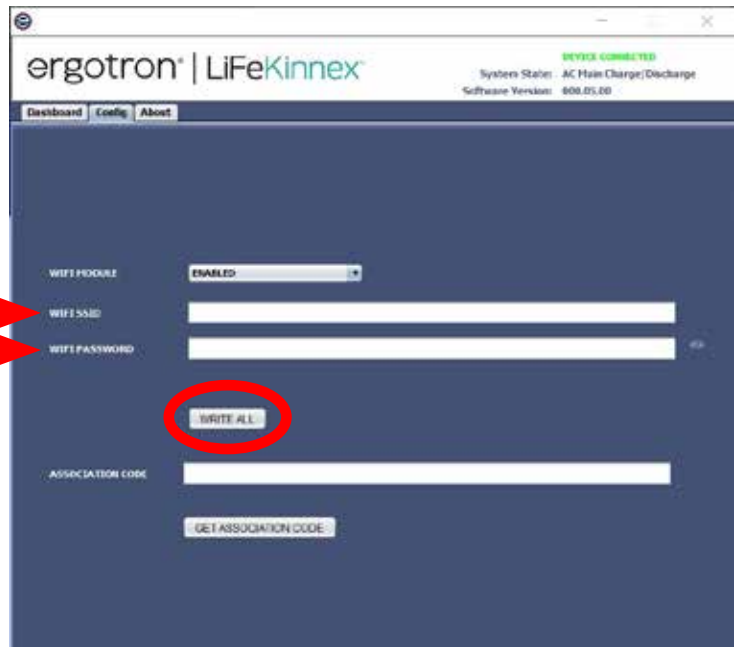

Power OFF device, then power ON device.

Confirm WiFi is connected.

Smart Dock

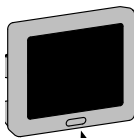
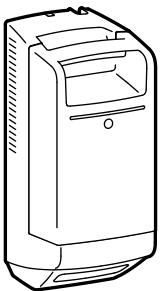

Turn OFF by pressing and holding power button until screen turns off.
Turn ON by pressing power button.

4-Bay Charger

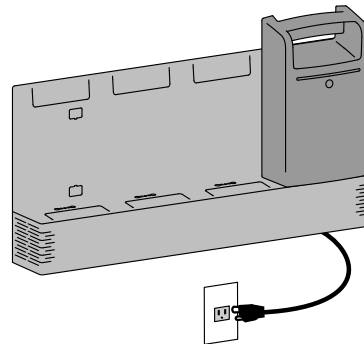

Unplug power cord to power OFF, then plug in power cord to power ON.



4 Add LiFeKinnex Device to eKinnex

From the LiFeKinnex dashboard, click on 'Config' tab.
Click on 'GET ASSOCIATION CODE'.
Select and 'Copy' the association code that appears.
(keyboard: ctrl + C to copy)

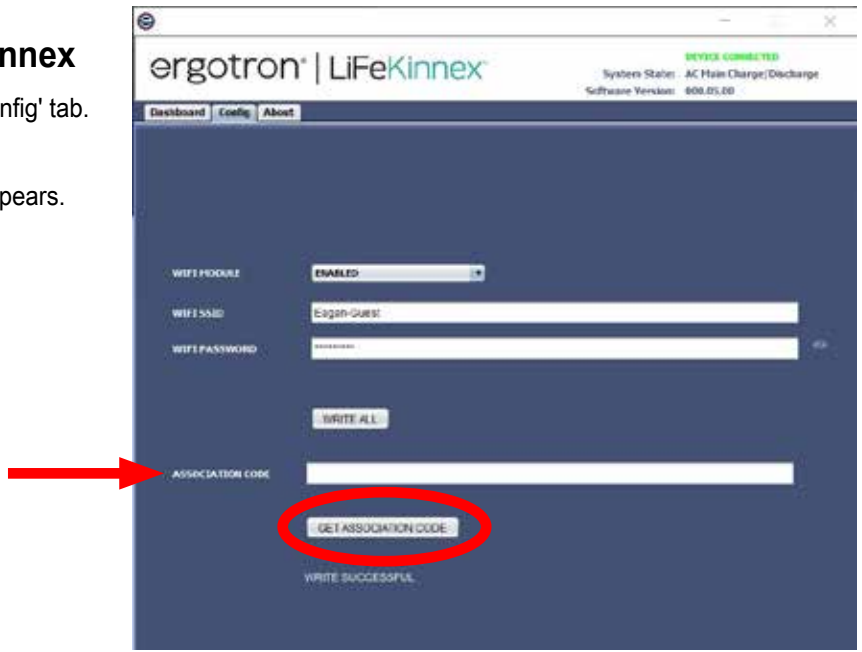

Log in to eKinnex: <https://lifekinnex.ekinex.com/login>

Smart Dock

In the left navigation pane of the eKinnex web portal, click on "CARTS" followed by "Add device" to the upper right.

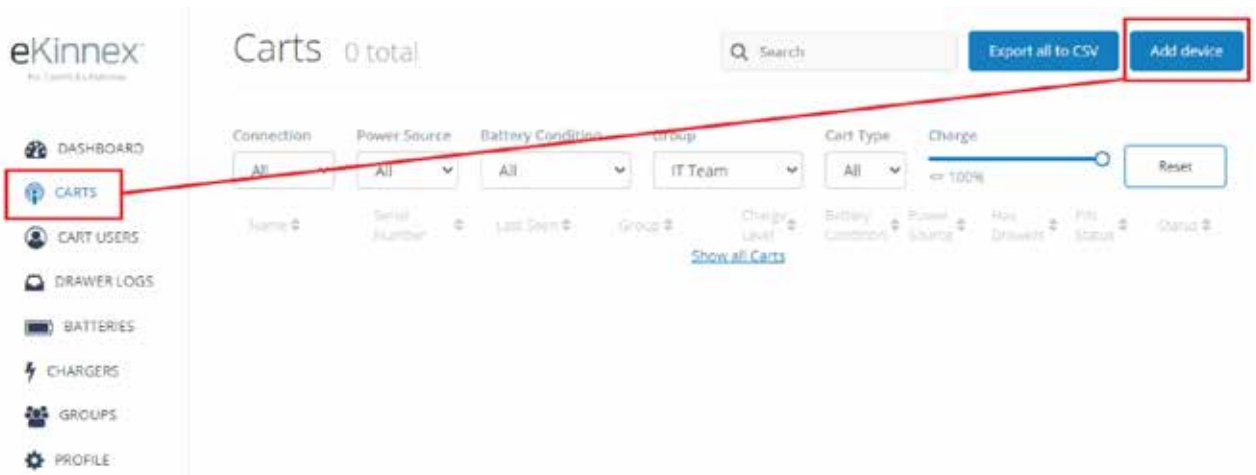

4-Bay Charger

In the left navigation pane of the eKinnex web portal click on "CHARGERS" followed by "Add device" to the upper right.

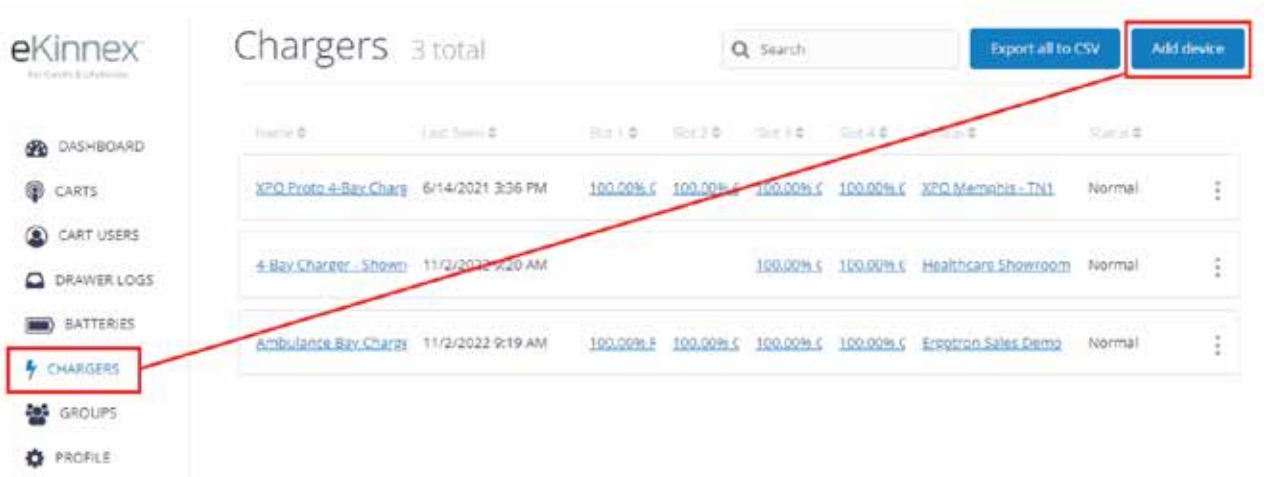

In the “Add device” dialogue box, fill in the fields.

Association Code:

Paste the Association Code you copied from the Config tab into the Association Code field (keyboard: ctrl + V to paste)

Device Name:

Think of this as the unique name given to each cart that will be on a printed label of each cart to distinguish one cart from all others. Also be prepared to tag this dock with this device name so when it is attached to a cart at a later time that cart will get the appropriate printed label adhered to the cart.

Group:

Select the sub-group the cart will be assigned or deployed to. Think of subgroups as different departments in the top-level hospital organization. I would recommend you create your sub-group structure prior to setting up each LiFeKinnex device.

Click: Add Device.

The device should now be added to the list with the given name.

Verify that the device is connected and communicating by checking the “Last Seen” timestamp, it should show within 1min of the current time.

Batteries will automatically create as they are attached to docks or chargers that are online and reporting to eKinnex.

When setting up multiple carts leave software open to avoid re-entering the Wi-Fi credentials.

Plug in the new device to USB and simply select “Write to device.”



For Warranty visit: www.ergotron.com/warranty

For Service visit: www.ergotron.com

For local customer care phone numbers visit: <http://contact.ergotron.com>

www.ergotron.com | USA: 1-800-888-8458 | Europe: +31 (0)33-45 45 600 | China: 400-120-3051 | Japan: japansupport@ergotron.com

© 2018 Ergotron, Inc. All rights reserved. Manufactured for Ergotron by Green Cubes Technology www.greencubestech.com.

LiFeKinnex™ is a registered trademark of Ergotron, Inc.

While Ergotron, Inc. makes every effort to provide accurate and complete information on the installation and use of its products, it will not be held liable for any editorial errors or omissions (including those made in the process of translation from English to another language), or for incidental, special or consequential damages of any nature resulting from furnishing this instruction and performance of equipment in connection with this instruction. Ergotron, Inc. reserves the right to make changes in the product design and/or product documentation without notification to its users. For the most current product information, or to know if this document is available in languages other than those herein, please contact Ergotron. No part of this publication may be reproduced, stored in a retrieval system, or transmitted in any form or by any means, electronic, mechanical, photocopying, recording or otherwise without the prior written consent of Ergotron, Inc., 1181 Trapp Road, Eagan, Minnesota, 55121, USA Patents Pending and Patented U.S. & Foreign. Ergotron is a registered trademark of Ergotron, Inc.